

FILENAME: D:\racine_co\mt_pleasant_village\Design\230387 - 90th Street Reconstruction\Design\230387_TRAFFIC CONTROL.dwg



1224 S Pine Street
Burlington, Wisconsin 53105
kapurinc.com

PROJECT:
90TH STREET RECONSTRUCTION

LOCATION:
VILLAGE OF MT. PLEASANT, RACINE COUNTY, WISCONSIN



RELEASE:
CONSTRUCTION PLANS

REVISIONS:

#	DATE	DESCRIPTION

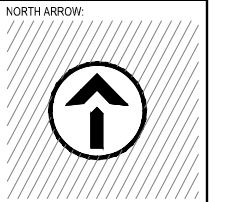

SCALE:
1" = 500'

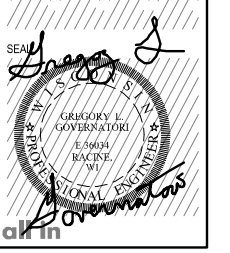

SHEET:
TRAFFIC CONTROL EXHIBIT

PROJECT MANAGER: GLG
PROJECT NUMBER: 23.0387
DATE: 2-12-2024

SHEET NUMBER:
EX

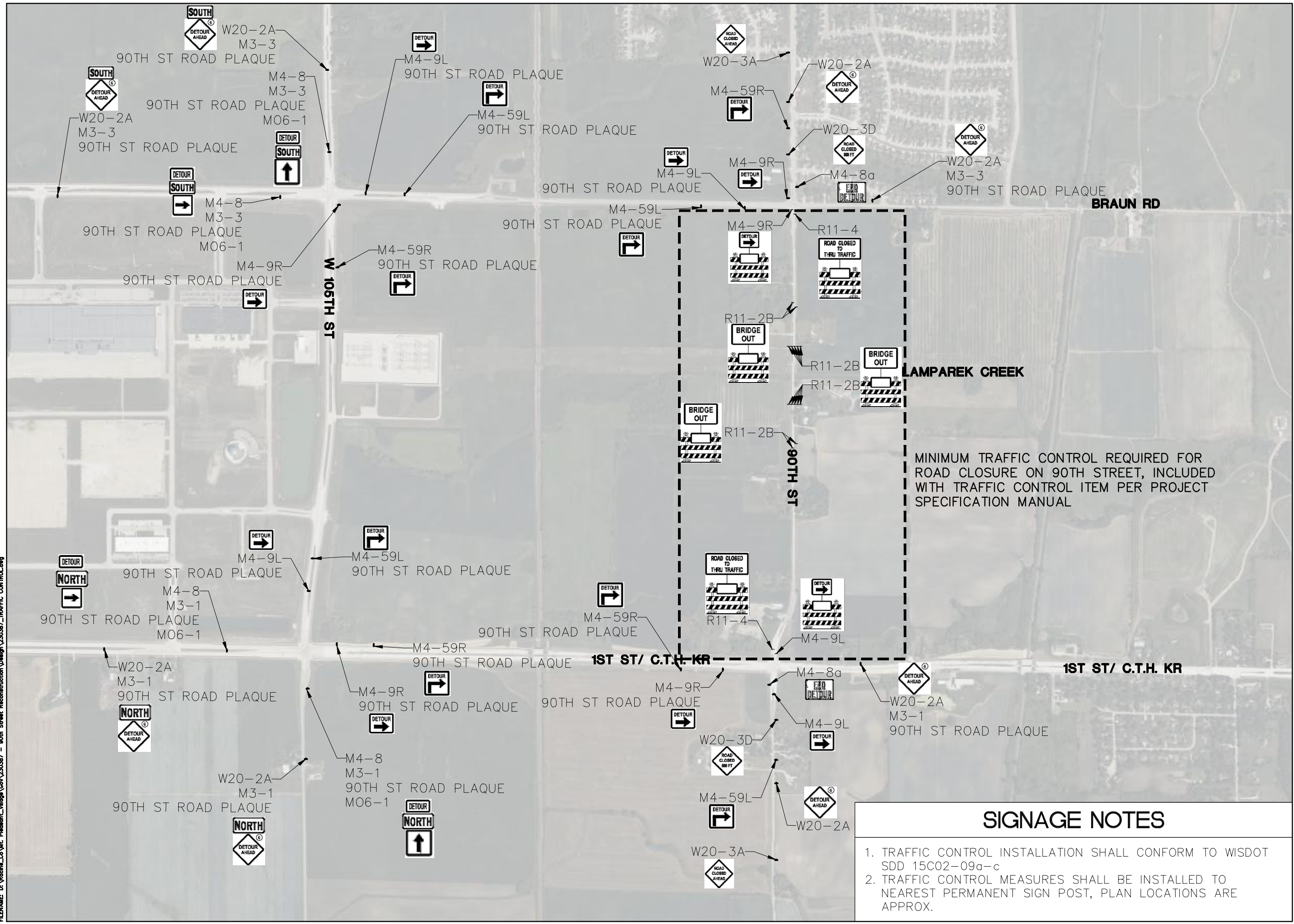

MINIMUM TRAFFIC CONTROL REQUIRED FOR ROAD CLOSURE ON 90TH STREET, INCLUDED WITH TRAFFIC CONTROL ITEM PER PROJECT SPECIFICATION MANUAL

SIGNAGE NOTES

1. TRAFFIC CONTROL INSTALLATION SHALL CONFORM TO WISDOT SDD 15C02-09a-c
2. TRAFFIC CONTROL MEASURES SHALL BE INSTALLED TO NEAREST PERMANENT SIGN POST, PLAN LOCATIONS ARE APPROX.